

SPECIFICATIONS:

INSULATION RESISTANCE: 100MΩ min. @ 500VDC.
 DIELECTRIC STRENGTH: 200VAC min. for 1 minute.
 OPERATING TEMPERATURE: -25°C to +70°C.
 PULL FORCE BETWEEN TERMINAL & BASE:
 (a) Normal type 2kgf for 1 minute.
 (b) Sealed type 5kgf for 1 minute.
 PULL FORCE BETWEEN BASE & BODY:
 (a) Normal type 2kgf for 1 minute.
 (b) Sealed type 5kgf for 1 minute.
 HAND SOLDERING: 350±5°C for 3sec. max.

MATERIALS:

BODY: Polycarbonate UL 94V-0 or Acrylic.
 BASE: Glass fiber polyamide, UL 94V-0.
 ILLUMINANT: Neon lamp or LED.
 TERMINAL: Copper alloy, tin plated over nickel.
 WASHER: Polyamide, UL 94V-0 or iron hoop.
 NUT: M10x0.75P or M15x1P iron.

Specifications and Dimensions subject to change

NI-01

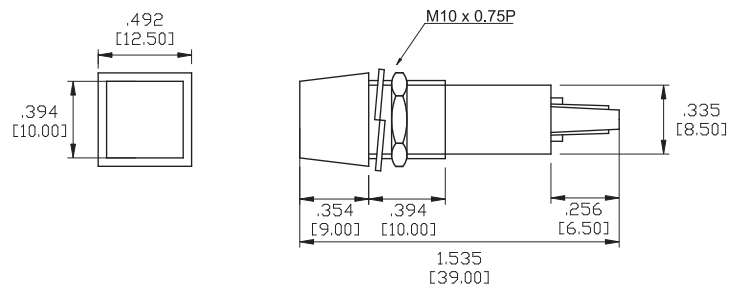

NI-02

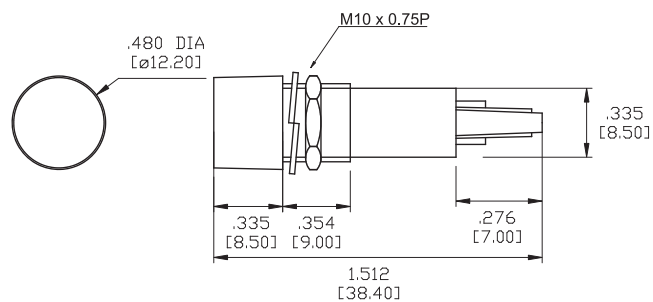

NI-03

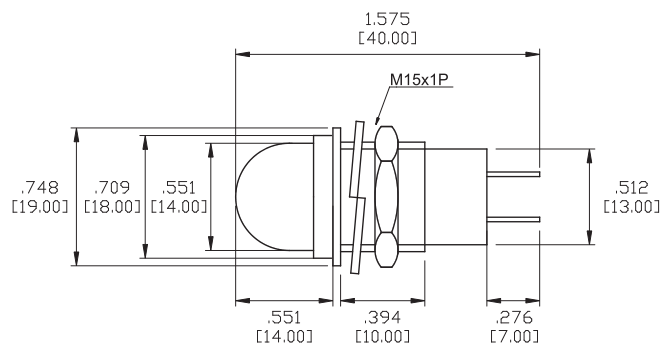

L-602 LED INDICATOR LIGHT
W/O Resistor 2V

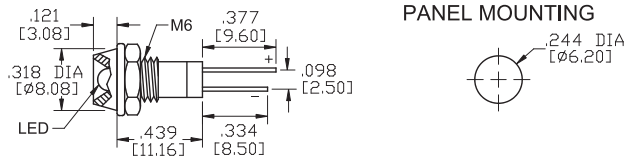

L-605 LED INDICATOR LIGHT
W/O Resistor 2V

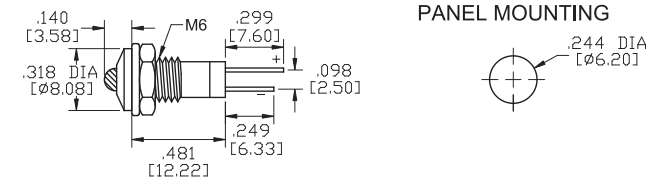

L-607 LED INDICATOR LIGHT
W/O Resistor 2V

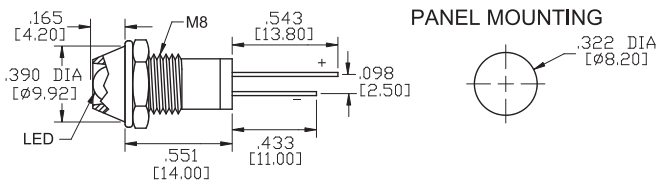

L-610 LED INDICATOR LIGHT
W/O Resistor 2V

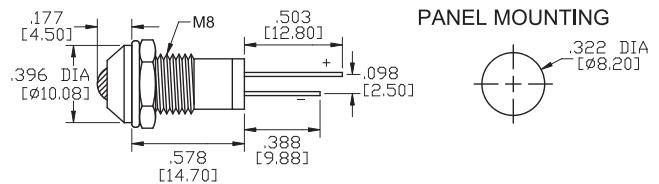

N-701 NEON / N-701L LED INDICATOR LIGHT
W Resistor 120V 220V / W Resistor 6V 12V 24V

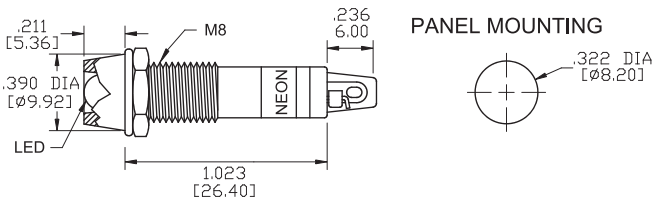

N-702 NEON / N-702P PILOT INDICATOR LIGHT
W Resistor 120V 220V / W Resistor 6V 12V 24V

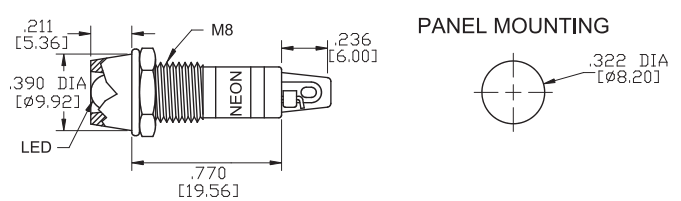

N-703 NEON INDICATOR LIGHT
W Resistor 120V 220V

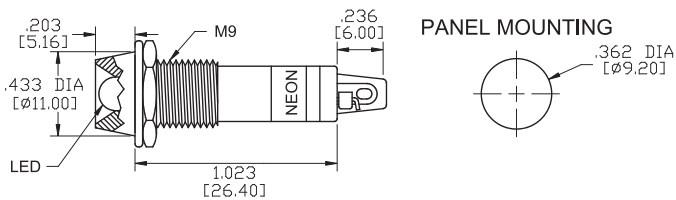

N-705 NEON / N-705L LED INDICATOR LIGHT
W Resistor 120V 220V / W Resistor 6V 12V 24V

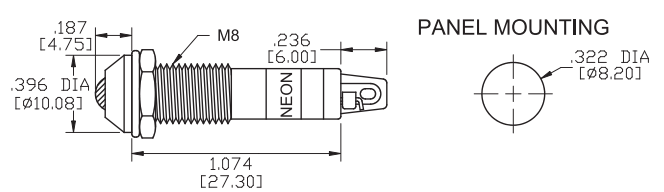

N-301 INDICATOR LIGHT
W Resistor 120V 220V

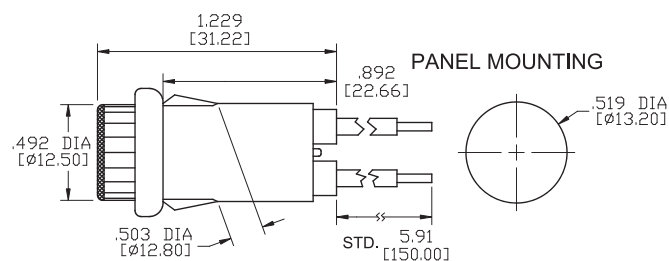

N-381 INDICATOR LIGHT
W Resistor 120V 220V

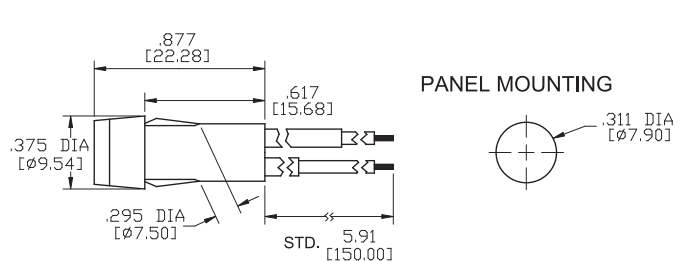

Toggle

Rocker

Slide

Pushbutton

AV

Rotary

Tact

Touch Key

Miscellaneous

N-369 INDICATOR LIGHT
W Resistor 120V 220V

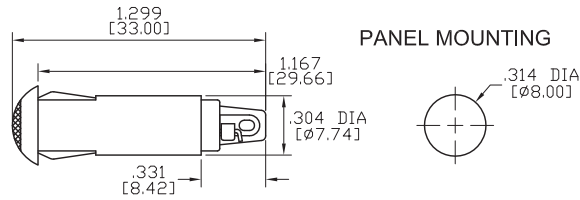

LED & LAMP COLOR OPTIONS

LED Colors

Code	Color
1	Red
2	Orange
3	Green
4	Yellow
5	Blue
6	White

Lamp Colors

Code	Color
1	Red
2	Orange
3	Green
4	Amber
5	Blue
6	White

VOLTAGE OPTIONS

Code No.	Voltage	Indicator Lights						
		L-6xx	N-7xx	N-7xxL	N-7xxP	N-3xx	LI-xx	NI-xx
1	2V	●						
2	6V			●	●			
3	12V			●	●		●	
4	24V			●	●		●	
5	120V		●			●		●
6	220V		●			●		●
7	5V						●	
8	48V				●			
9	100V		●			●		●
10	240V		●			●		●

● :AVAILABLE

HOW TO ORDER

